

An abstract sculpture composed of numerous thin, white, curved ribbons that intertwine and loop together, creating a dense, complex structure. The ribbons are set against a solid black background, which makes the white forms stand out sharply. The lighting is dramatic, highlighting the edges and curves of the ribbons, giving them a three-dimensional appearance. The overall composition is dynamic and organic, suggesting movement and intricate design.

GRADUATE  
**INPROCESS 18**

GAUD + PSPD  
School of Architecture

# TABLE OF CONTENTS

## GRADUATE ARCHITECTURE + URBAN DESIGN

Forward 003

### Master of Architecture

#### *Core Design Studios*

Semester 1 005

Semester 2 017

Semester 3 025

#### *Comprehensive Design Studios*

Semester 4 037

#### *Advanced Option Design Studios*

Semester 5 049

Semester 6 065

### Master of Science in Architecture

#### *Design Studios*

Semester 1 075

Semester 2 049

#### *Thesis*

Semester 3 083

### Master of Science in Architecture and Urban Design

#### *Design Studios*

Semester 1 089

Semester 2 093

#### *Culmination Project*

Semester 3 095

### Seminars

Core Media 099

Core Elective 103

International Programs 115

## PROGRAMS FOR SUSTAINABLE PLANNING AND DEVELOPMENT

Forward 121

Master of Science in City and Regional Planning 123

Master of Science in Urban Environmental Systems Management

Master of Science in Historic Preservation

Bachelor of Science in Construction Management

Master of Science in Facilities Management

Interdisciplinary Studios 125

Research and Public Events 143

## RESEARCH

Forward 145

Agent Structures 147

Atacama Workshop 149

Geospatial Mapping 151

Occupy Wall Street Conference 153

## SCHOOL OF ARCHITECTURE

### *Lectures, School Culture, Events and Exhibitions*

Lecture Series 155

School Culture 157

Faculty 159

Credits 160

Pratt School of Architecture

## DEAN'S FORWARD

InProcess 18 marks the transformation of a single book presenting the work of all of the School of Architecture's programs into two separate volumes. One volume has been dedicated to the undergraduate program, and the new Graduate InProcess is the first of this series to be dedicated solely to the GAUD (Graduate Architecture and Urban Design) programs and the primarily graduate courses of study in the PSPD (Programs for Planning and Sustainable Development). This change has been precipitated by the extraordinary growth in quality, diversity and size of the school over the last several years. The expansion into two volumes allows each book to widen its coverage of many more studios and courses, and also allows the individual programs to articulate their particular vision and interest.

The GAUD is actually three separate programs; the three year professional Master of Architecture program and the three semester Post-professional programs of Master in Science in Architecture and Master of Science in Architecture and Urban Design. The two post-professional programs began as a single program in the 1960's eventually reaching their current articulation in the 1980's. These two programs offer students with professional degrees to re-think the disciplines of urban design and architecture, and strike out in their own original research directions. The professional Master of Architecture was founded in 2000, and brings together students of all collegiate backgrounds making this a program of extraordinary intellectual richness. In recent years, this program has been recognized with high rankings, and now offers students a sophisticated and diverse range of design tools and experiences. All of these programs stress advanced computation techniques, new collaborative teaching models and an emphasis on meeting the societal and ecological challenges of the day. All three programs share advanced studios in the latter semesters, exploring research themes reflecting our rapidly changing urban culture and the particular interests of the design critics.

The PSPD (Programs for Planning and Sustainable Development) are a unique cluster of 5 primarily graduate programs with a single undergraduate program. The programs have broad interests, but share a common goal in advancing a vision of a just and ecologically responsible urban culture, using the most advanced tools and techniques available in their respective field. Several of these programs have a highly developed research agenda with a strong record of sponsored research.

The Master of Science in City and Regional Planning is the oldest and largest of these programs, founded in the 1950's and now grown to almost 100 students. This 64 credit program attracts a diverse enrollment dedicated to an equitable, diverse and economically dynamic city. The Pratt Center grew out of this program, a nationally recognized model for urban research. The Master of Science in Urban Environmental Systems Management also grew out of the planning program, developing its special emphasis on green infrastructure for 21st century cities. This graduate program is relatively new but already has developed impressive research initiatives.

The other three programs, the Master of Science in Historic Preservation, the Bachelor of Science in Construction Management and the Master of Science in Facilities Management are more focused on buildings, but their emphasis on urban buildings and their understanding of management as an aspect of contemporary urban culture offers them many opportunities to share courses and professors with all of the other programs in the PSPD. The Construction Management and Facilities Management programs are both several decades old, and draw upon the expertise of New York City's building and construction industry leaders. Many of these leaders are in fact graduates of these programs. The newest of all of our programs, the graduate Historic Preservation program, offers a unique perspective on preservation, emphasizing both conservation and community, with an emphasis on the relationship between a culture and its context. This program benefits from a very diverse group of students sharing a passion for cities and their history.

All of these programs in this volume of InProcess share the same commitments to urban culture and a belief that their discipline can make a difference in meeting the challenges of the day. These exceptional programs will continue to nourish and develop new leaders in their field, and it is their work we celebrate as a creative community in this volume of Graduate InProcess 18.

Thomas Hanrahan, Dean

Graduate Architecture and Urban Design

## CHAIR'S FORWARD

Being the first issue of InProcess dedicated entirely to Graduate Architecture at Pratt Institute, the Graduate Architecture and Urban Design (GAUD) department provides an introduction to the programs progressive design environment for advanced architectural research located in New York City. GAUD proposes speculative debate and experimental architectural production based on a relational construct among theoretical inquiry, computational research, digital design, and technological investigation. To this end, GAUD seeks to formulate a contemporary approach to architecture that is "ecological" in the sense that it provides collective exchanges which are both trans-disciplinary and trans-categorical. This ecological approach encourages feedback relationships among architecture, landscape, urbanism, technology, software programming, industry, manufacturing, political agencies, theoretical studies, as well as categories and disciplines that are newly emerging in contemporary culture. This approach seeks to productively intensify heterogeneous interests and agencies.

Students in all three GAUD programs are immersed in an exploratory design studio culture. The three distinct degrees in two programs - Architecture and Urban Design - resonate through shared coursework, students, faculty, and events, intensifying the School of Architecture's unique position within an art and design institute. This mix supports the ability to integrate diverse theoretical and technical knowledge in speculative design work while emphasizing critical thinking / critical making. Students and faculty are engaged in the design of contemporary experimental architectural projects and the integration of academically rigorous history and theory, computer media, and technology seminar courses.

GAUD has a diverse faculty of distinguished educators and practicing architects, excellent facilities, and trans-disciplinary connections with the well-known art and design departments of Pratt Institute. Distinguished visitors present their work to graduate students on a regular basis in research forums, guest studios, and seminars. Faculty and students in both programs come from national and international backgrounds.

In addition, the program sees architectural innovations in both the theory and practice of architecture and the interconnected phenomena out of which it emerges. Recent courses in GAUD have investigated such topics as iterative processes, fluid systems, emergent phenomena, logics of organization, complex urbanisms, globalization and politics, computational logics, material performance, and speculative fabrication.

William J. MacDonald, Graduate Chair

GAUD

PSPD

RESEARCH

SOA

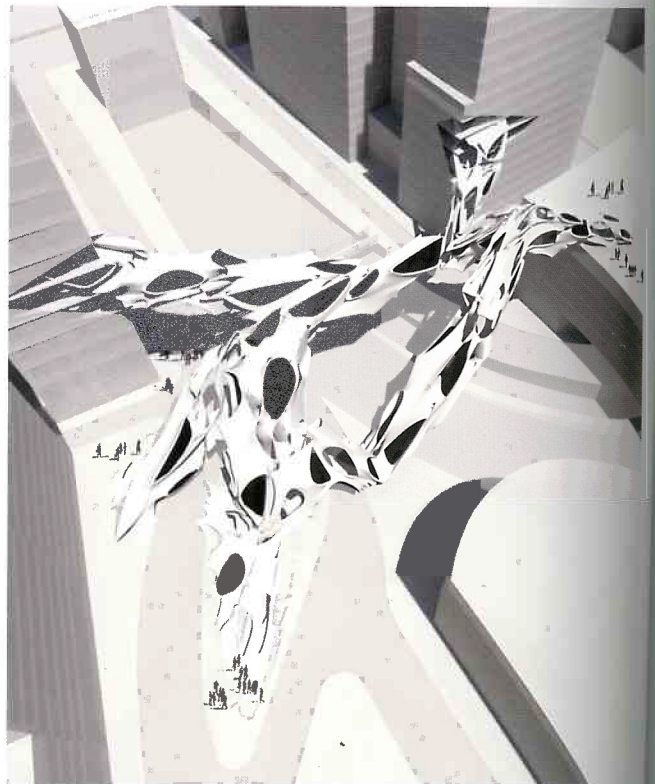

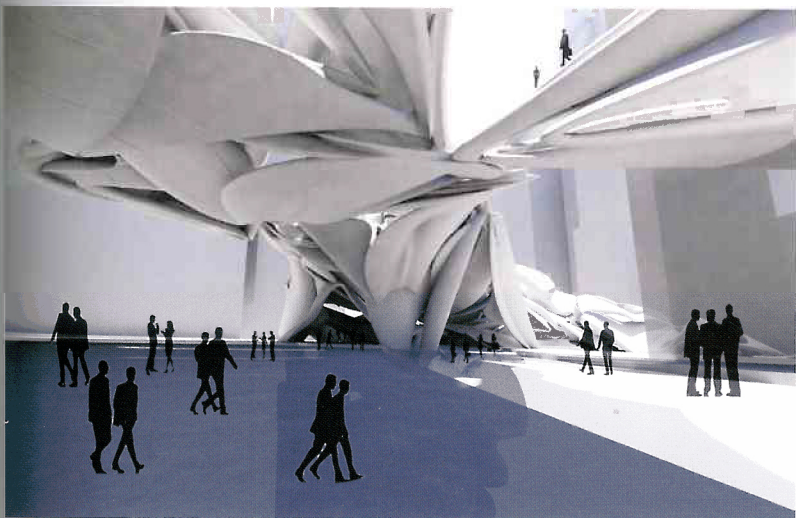
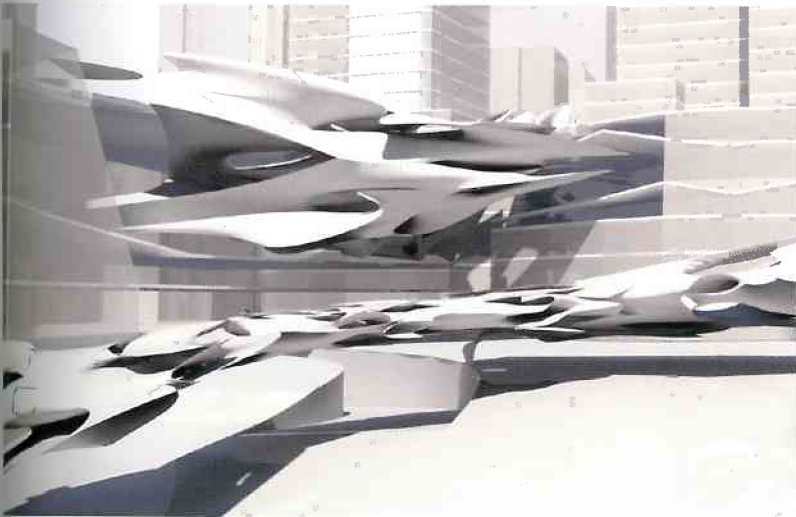

'Multi-Media ART Center' [MMAC]  
Brooklyn Battery Tunnel Entrance to Manhattan, NY

In concert with Mayor Bloomberg's "We are Made in NY" campaign, a multi-platform initiative promoting the city's technology and digital sector that joins the resources of NYC, existing businesses, with the advancement of new associated institutions and start-up companies, the studio proposed a Multi-Media ART Complex [MMAC] along with the development of a city plaza at the Brooklyn Battery Tunnel Entrance in Manhattan. What is at stake for the studio is 'How does one conceive of a new kind of 'design and high technology guild' environment in the city, that needs to be comprised of both private and public concerns?' How do we strive to create a continually evolving 'mutual-istic environment' of form, space and network influence for the 21st century? The approach and methodology for the studio was to investigate these issues via an exploration of 'systemic hybridity' in form and space, a 'MU-T-en' environment, which oscillates between system and object, privacy and publicity, community and individual. The studio takes advantage of the Multi-Media Complex and is multi-valent relations to these issues as means of addressing this cultural problematic.

William MacDonald, critic

- |   |   |   |   |
|---|---|---|---|
| a | b | a | d |
|   |   | d |   |
| c |   | a |   |
- a. Katia Loizou
  - b. Isaac Michan
  - c. Asli Agirbas
  - d. Anja Pavlin

## InProcess 18 Publication Staff:

**Megan Hurford:**  
Graduate Design, Production, Coordination  
**Maria Nikolovski :**  
Graduate Design, Production, Coordination

**Nicholas Meier:**  
Undergraduate Design, Production,  
Coordination, Supplemental Photography  
**Erin McLaughlin:**  
Supplemental Design, Archival Coordination  
**Taylor Sams:**  
Supplemental Design, Text and Archival Coordination  
**Intiporn Rojanasopondist:**  
Photography, Supplemental Design  
**Kevin Chang:**  
Supplemental Design, Archival Coordination

**Andreas Theodoridis**  
PSPD Archival Coordination

The student staff of InProcess 18 would like to extend a thank you to the Fall 2011-Spring 2012 student body and professors for their astounding contribution of over 260 gigabytes of work as well as many outstanding models and drawings.

Additionally we would like to thank Kurt Everhart, Pamela Gill, and Adam Kacperski for their tireless efforts and Thomas Hanrahan, William MacDonald, and Philip Parker for their invaluable input and guidance.

## Pratt Institute School of Architecture Administration:

Thomas Hanrahan, Dean  
Kurt Everhart, Assistant to the Dean  
Pamela Gill, Assistant to the Dean

## Pratt Institute Administration:

Thomas F. Schutte, President, Pratt Institute  
Mike Pratt, Chair to the Board of Trustees  
Peter Barna, Provost

## Graduate Administration:

William Mac Donald, GAUD Chair  
Philip Parker, Assistant GAUD Chair  
Erin Murphy+Erika Schroeder, Assistants to GAUD Chairs

## Undergraduate Administration:

Erika Hinrichs, UA Chair  
Jason Lee, Assistant UA Chair  
Adam Kacperski, Assistant to the Chair  
Latoya Johnson, Administrative Assistant  
Harriet Markis, Construction Management Chair

## PSPD Administration:

John Shapiro, Chair of City and Regional Planning  
Eric Allison, Coordinator of Historic Preservation  
Jaime Stein, Coordinator of Environmental Systems Management  
Harriet Markis, Chair of Construction Management

## PCCD Administration:

Adam Friedman, Director of Pratt Center for Community Development

**Additional Image Credits:**  
Cover Image: Michelle Fowier  
David Ruy, critic  
Interior Cover: Chang-Kuang Chao  
Sulan Kolatan, critic  
Supplemental Photography:  
Tim Street Porter p. 148-149

Printed in Canada

The following hardware and software was used for this publication:

3 Apple Mac Pro 3 desktop computers  
4 Apple iMac desktop computers  
Nikon D300 DSLR camera  
Cannon EOS E7 camera  
Cannon EOS 6D  
Adobe Creative Suite CS5  
Hewlett Packard Color LaserJet 5550dn  
Hewlett Packard Color Laser Juet 6015dn  
Netgear ReadyNAS Duo 500Gb network drive  
Western Digital 4TB network drive  
Type Set to font families Trade Gothic LT Standard, Interstate and Gotham